

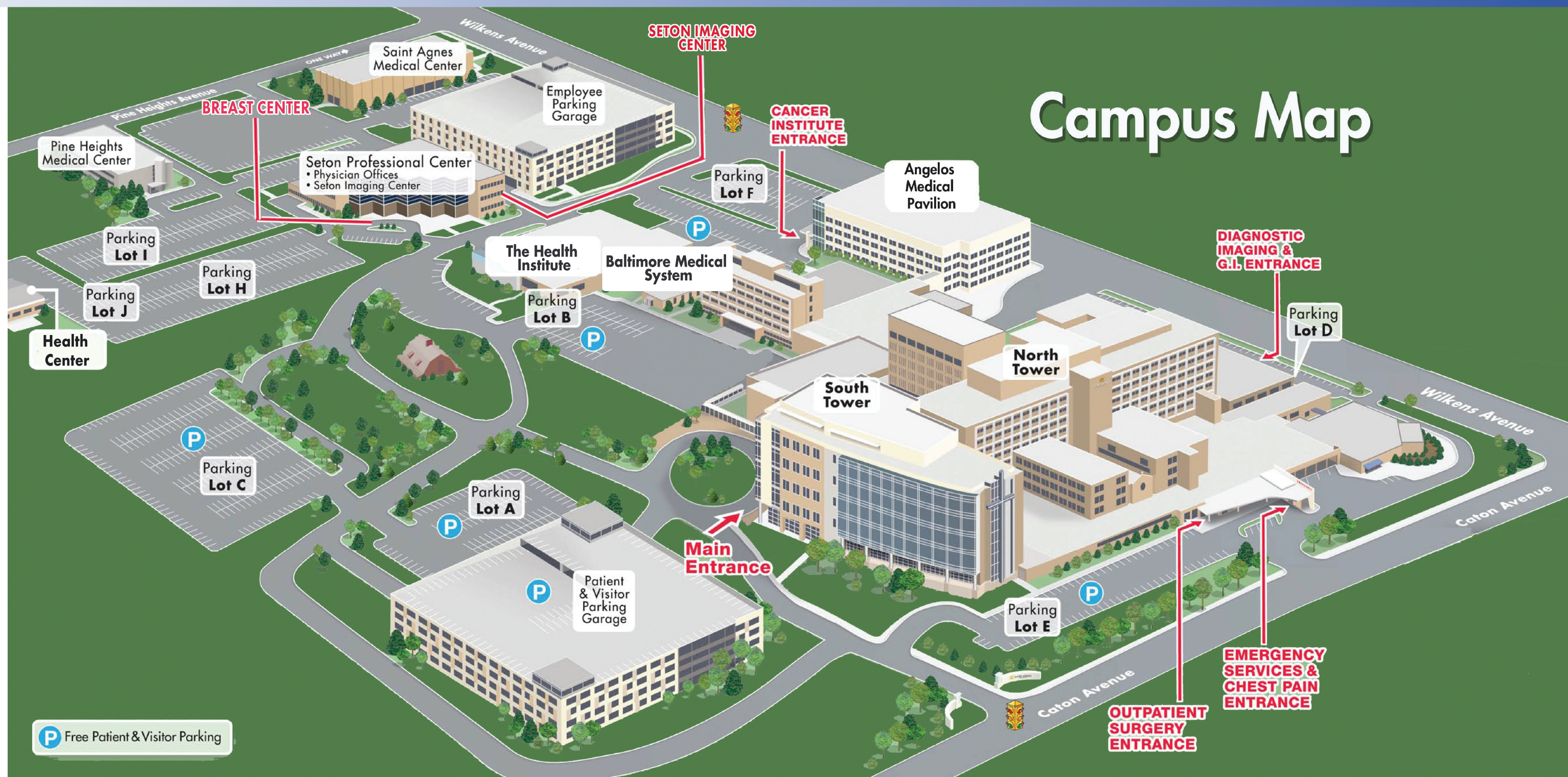

Ascension  
Saint Agnes



### WELCOME

As we continue to transform our campus to better serve you, our goal is to make your visit as pleasant and comfortable as possible. We've prepared this guide to help you navigate our hospital.





# Ascension Saint Agnes

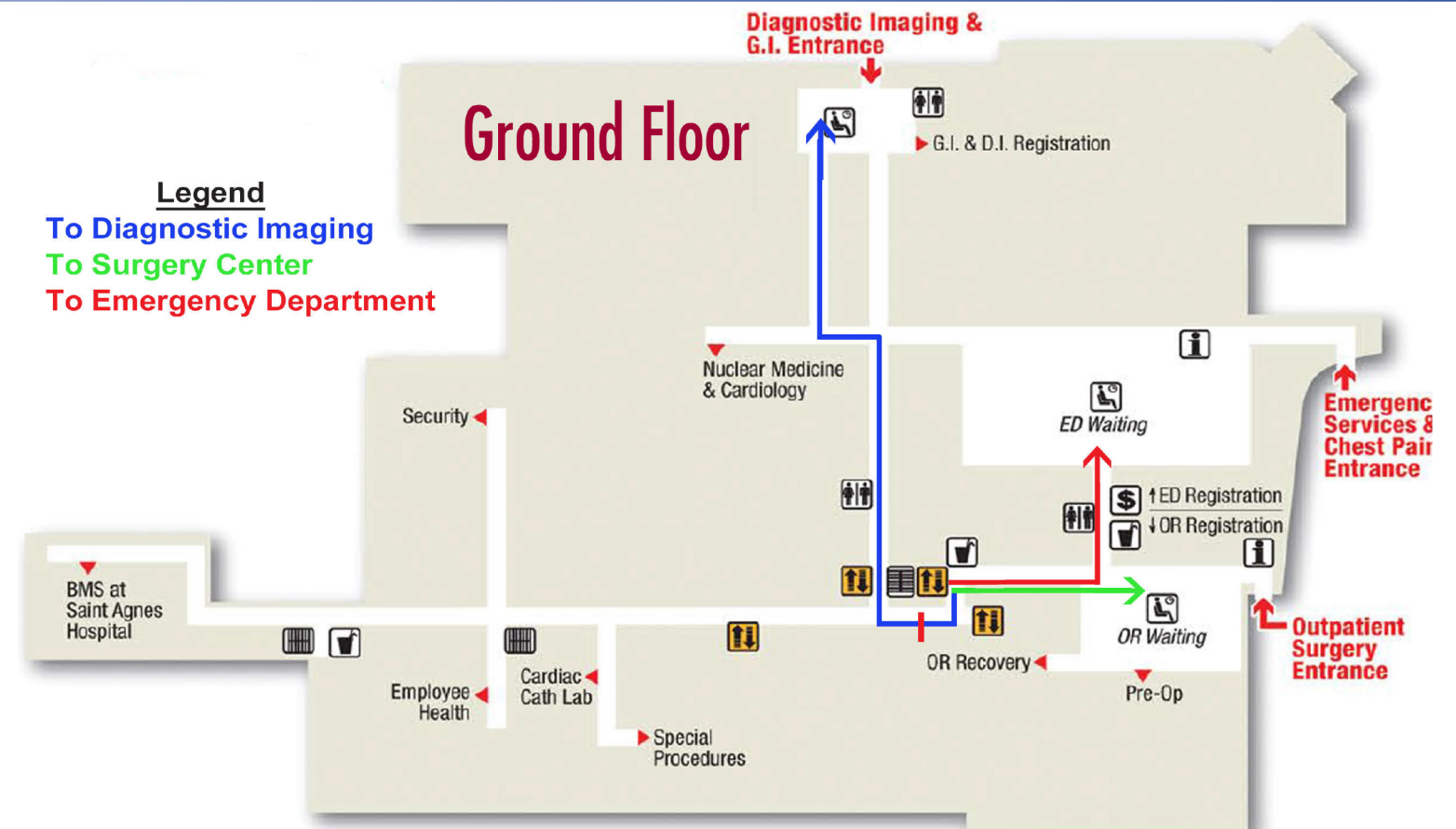
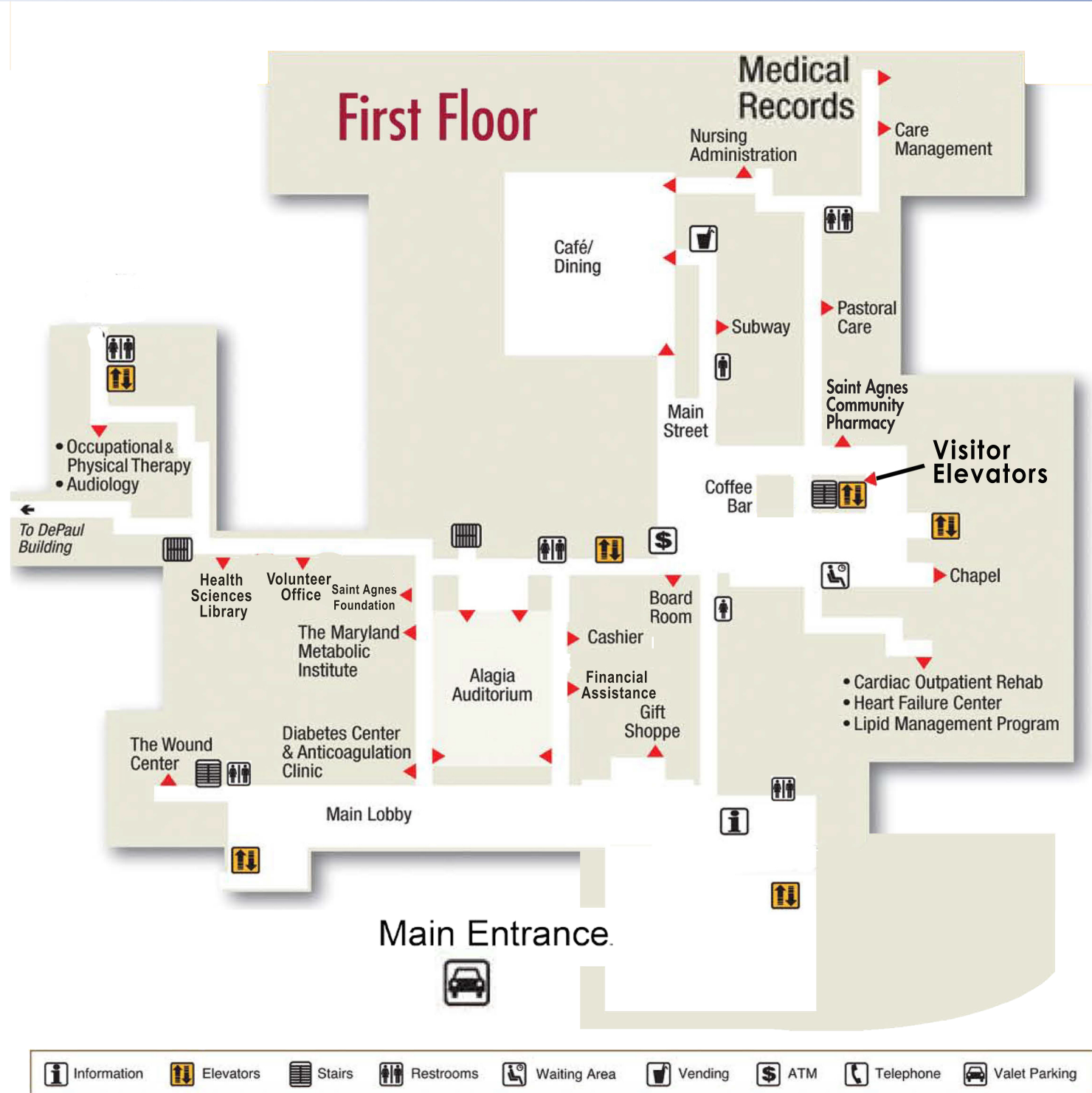

## Valet Service

Main Entrance  
7:30 am - 4:00 pm  
Cost: \$5

## Banking

A Bank of America ATM is located on the first floor. ATM's affiliated with the Hospital's Credit Union are located on the first floor and in the Emergency Department waiting area.

## Visiting Hours

General visiting hours are 8:30 am to 8:30 pm however, hours and policies may vary by unit. Please check with the front desk before visiting.

## Dining Options

Saint Agnes offers a full-service cafe, Subway Sandwich shop, as well as a coffee bar, all located on the first floor.

## Gift Shoppe

Our Gift Shoppe is located on the first floor off the main lobby.